

CS-36

TYPE MOLDS

**Cathodic Protection
Cable to Vertical Steel Surface
For AWG Conductors**

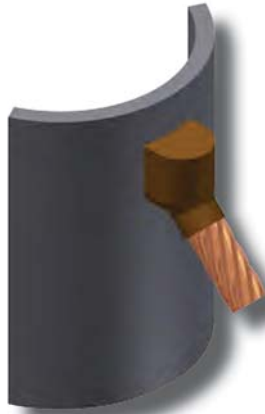

NOTE

Welding To Ductile Iron Pipe: When welding to ductile iron pipe, use weld metal and molds designated for cast iron.

Section 7 - Products for
Cathodic Protection

MOLDS FOR AWG CONDUCTORS						
Cable Size	Surface	Mold #	Price Key	Weld Metal	Handle Clamps	Lead Time
#6 Sol†	Flat (12" & Larger pipe)	M-142	18 †	15CP	40-4565-00	2
	3/4" to 3 1/2" pipe	M-150	18 †	15CP	40-4565-00	2
	4" to 10" pipe	M-151	18 †	15CP	40-4565-00	2
#6	Flat (12" & Larger pipe)	M-144	18 †	15CP	40-4565-00	2
	3/4" to 3 1/2" pipe	M-152	18 †	15CP	40-4565-00	2
	4" to 10" pipe	M-153	18 †	15CP	40-4565-00	2
#4 Sol	Flat (12" & Larger pipe)	M-145	18 †	25CP	40-4565-00	2
	3/4" to 1 1/2" pipe	M-186	18 †	25CP	40-4565-00	2
	2" to 4" pipe	M-187	18 †	25CP	40-4565-00	2
	5" to 10" pipe	M-188	18 †	25CP	40-4565-00	2
#4	Flat (12" & Larger pipe)	M-146	18 †	25CP	40-4565-00	2
	3/4" to 1 1/2" pipe	M-189	18 †	25CP	40-4565-00	2
	2" to 4" pipe	M-190	18 †	25CP	40-4565-00	2
	5" to 10" pipe	M-191	18 †	25CP	40-4565-00	2
#2 Sol	Flat (14" & Larger pipe)	M-147	18 †	25CP	40-4565-00	2
	1" to 1 1/2" pipe	M-192	18 †	25CP	40-4565-00	2
	2" to 4" pipe	M-193	18 †	25CP	40-4565-00	2
	5" to 12" pipe	M-194	18 †	25CP	40-4565-00	2
#2	Flat (14" & Larger pipe)	M-148	18 †	32CP	40-4565-00	2
	1" to 1 1/2" pipe	M-195	18 †	32CP	40-4565-00	2
	2" to 3" pipe	M-196	18 †	32CP	40-4565-00	2
	4" to 6" pipe	M-197	18 †	32CP	40-4565-00	2
	8" to 12" pipe	M-198	18 †	32CP	40-4565-00	2
#1	Flat (18" & Larger pipe)	M-6117	19 †	45CP	40-4565-00	4
	1 1/2" to 2 1/2" pipe	M-6118	19 †	45CP	40-4565-00	2
	3" to 4" pipe	M-6119	19 †	45CP	40-4565-00	2
	5" to 10" pipe	M-6120	19 †	45CP	40-4565-00	2
	12" to 16" pipe	M-6121	19 †	45CP	40-4565-00	2

† For Wire Size #14 to #10 Solid, 38-0200-00 Sleeve/Weld Req'd

CS-37

TYPE MOLDS

**Cathodic Protection
Cable to Vertical Cast Iron
For AWG Conductors**



DO NOT use Type CS-37 molds on Soil Pipe (ASTM A74-82). A test weld should be made on a section of the pipe being used to determine the possibility of detrimental metallurgical effects.

MOLDS FOR AWG CONDUCTORS						
Cable Size	Surface	Mold #	Price Key	Weld Metal	Handle Clamps	Lead Time
#6 Sol†	Flat (30" & larger pipe)	M-2594-S	18 †	25CI	40-4565-00	2
#6	Flat (30" & larger pipe)	M-2594	18 †	25CI	40-4565-00	2
#4 Sol	Flat (30" & larger pipe)	M-2595-S	18 †	32CI	40-4565-00	4
#4	Flat (30" & larger pipe)	M-2595	18 †	32CI	40-4565-00	2
#2 Sol	Flat (30" & larger pipe)	M-2596-S	19 †	45CI	40-4565-00	4
#2	Flat (30" & larger pipe)	M-2596	19 †	45CI	40-4565-00	2
#1	Flat (30" & larger pipe)	M-2597	19 †	65CI	40-4565-00	4

† For Wire Size #14 to #10 Solid, 38-0200-00 Sleeve/Weld Req'd

- For sizes not listed, contact thermOweld®.
- Molds listed are for concentric stranded cable. Add suffix "-S" to mold number for solid conductors.
- For expedited service, contact thermOweld®.
- To order weld metal for use with EZ Lite Remote® insert TW before and EZ after weld metal number.
- Required Tools;
 - Handle Clamps w/ Flint Ignitor (see chart for correct handles)
 - † ~ Sold complete with handles. If not required, specify MOLD NUMBER followed by suffix "-G".
 - 38-0309-00 ~ Flint Ignitor or 38-EZLT-RU EZ Lite Remote®
- Other recommended accessories;
 - 40-0319-01 ~ Mold Cleaner for cartridge sizes #15-#65
 - 38-3922-00 ~ Mold Cleaning Brush
 - 38-0135-00 ~ Cable Cleaning Brush
 - 38-0101-00 ~ Rasp

Welding To Vertical Pipe (CS-37 only): To weld to 4" to 24" vertical pipe, add pipe size to mold number. Example: To weld #1 str cable to 6" vertical pipe, the mold number would be M-2597-6. To weld to pipe 30" and larger, use flat surface mold.